

DURBIN INDUSTRIAL VALVE, Inc.



Durbin Pressure Reducing Valves
RV Series





Durbin Pressure Reducing Valves RV Series

Feature:

True 1:1 Ratio Value

Maximum Pressure:
250 PSI (17 bar)

Maximum Temperature:
450° F (232° C)

Standard Port Sizes:
1/2" - 1" NPT

BSPT PORT SIZES ALSO AVAILABLE UPON REQUEST

Cv Ratings:

RV4 - 6.5
RV5 - 11.0
RV6 - 15.0

For:
Inert Gases
Steam



The Durbin RV™ is a one of a kind series of true 1:1 ratio valves. Since its original introduction to the market in mid 1990's. It has become one of Durbin's most innovative valves.

The set point of the Durbin RV™ Valve is controlled by applying load pressure to the top of the diaphragm. The valve then opens against the stainless steel internal spring allowing media to pass through the valve.

The downstream pressure is applied to the bottom of the diaphragm through an external sensing line. When the downstream pressure equals the load pressure, the spring raises the stem and closes the valve.

The Durbin RV™, a perfectly re-engineered valve, it is also commonly used as replacement for the GPK-4T type valves made by *Leslie™.

The Durbin RV™ pressure reducing valve is made from a non-lead cast bronze for use in steam, air, gas or liquid.

The Durbin RV valve is a re-energized, cost effective replacement to its cast iron competitors.

DISCLAIMER:

*Durbin Industrial Valve, Inc. does not have any affiliation with Leslie Valve™.

DURBIN VALVE



The Durbin RV™ Pressure Reducing Valve is a self regulating control valve used to reduce header pressure to a lower level and maintain this pressure over time. This valve operates by using a downstream sensing line that is plumbed into the dome. This line pressure acts on the lower side of the piston to create a balance to the instrument air that is set the desired outlet pressure. If 10 PSI is what is desired out of the valve, then 10 PSI is applied to the instrument air port on the lid/cover. The valve will remain open until the downstream pressure pushing on the piston matches the instrument air. As the pressure drops, the valve will open until pressure is back to the desired level.

The body is constructed of a high grade non-lead cast bronze for use with steam, air, gas or liquid. Unlike its cast iron competitors, the RV has replaceable components. If the body becomes damaged overtime, it can be replaced without having to replace the entire valve. Similar valves have a one piece body/dome design that limits repair. The RV's design allows for easy and cost effective repair.

The trim on the RV is constructed of 17-4 ph stainless steel. Unlike its competitors, the RV uses a high strength, high temperature thermal plastic for its trim seal. The seal is hard enough to withstand debris and impurities in the fluid, but soft enough to provide a positive shut off.

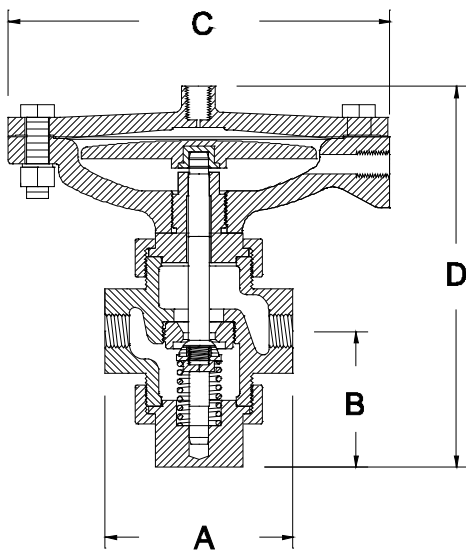

DIMENSIONS:

VALVE		A	B	C	D
RV4, RV5, RV6	IN	4-1/4	3	8-3/4	8-3/4
	mm	108	76	222	222

WEIGHT	LBS	Kg.
RV4	32.0	14.5
RV5	32.0	14.5
RV6	32.0	14.5



Parts List

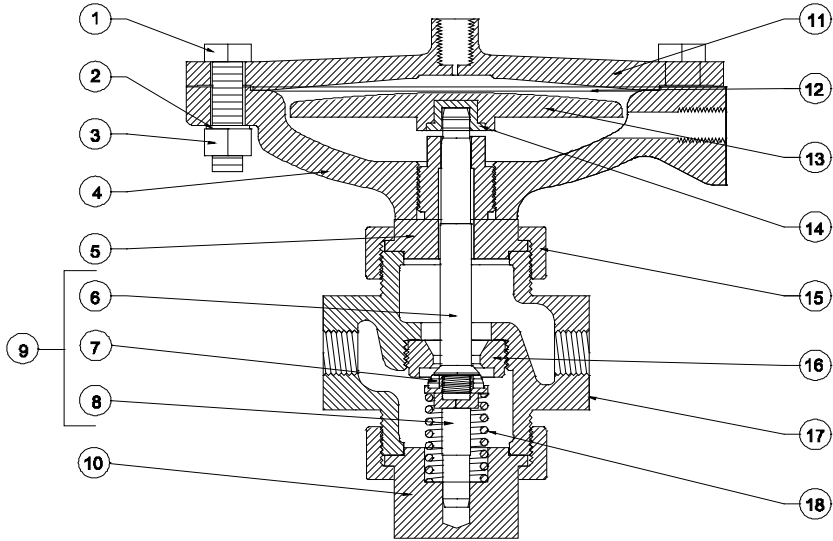

	DESCRIPTION	RV4 1/2" NPT	RV5 3/4" NPT	RV6 1" NPT
1	HEX BOLT	RV512	RV512	RV512
2	LOCK WASHER	RV516	RV516	RV516
3	HEX NUT	RV513	RV513	RV513
4	DOME	RV502	RV502	RV502
5	ADAPTOR	RV508	RV508	RV508
6	UPPER STEM	RV407	RV507	RV607
7	SEAL	C343-12VP	C343-34VP	C343-10VP
8	LOWER STEM	RV405	RV505	RV605
9	STEM ASSEMBLY	RV415	RV515	RV615
10	BOTTOM CAP	RV503	RV503	RV603
11	COVER	RV510	RV510	RV510
12	DIAPHRAGM	RV511	RV511	RV511
13	PISTON	RV509	RV509	RV509
14	PISTON BUSHING	RV521	RV521	RV521
15	UNION NUT	C663-026D	C663-026D	C663-026D
16	SEAT	RV414	RV514	RV614
17	BODY	RV400	RV500	RV600
18	SPRING	D293-003D	D293-003D	D293-021D



DURBIN

VALVE INSULATION SYSTEM

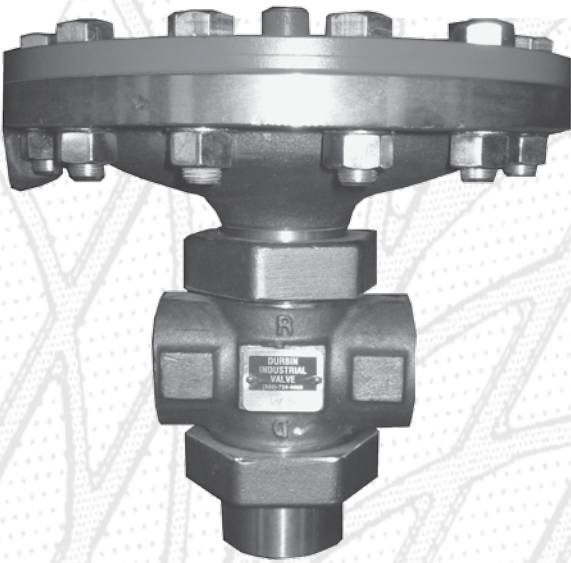

BEFORE



AFTER



- Quality Materials - standards for material longevity
- Low Cost - below competitor's prices
- Easy Installation - pre-finished designs with hook and loop fasteners
- Employee Safety - coating over fiberglass; insulates
- Energy Efficiency - controls heating and cooling temperatures

FOR MORE INFORMATION ABOUT THIS INNOVATIVE PRODUCT, PLEASE CONTACT ONE OF OUR DURBIN SERVICE REPRESENTATIVES.



WARNING

Overpressuring any portion of a valve and/or device may cause damage to the valve or personal injury.

Only a qualified person should install or service Durbin valves.

DISCLAIMER:

Information may be updated or changed at any time and without notice and may contain technical inaccuracies and/or typographical errors. Durbin Industrial Valve, Inc. shall not in any event be liable for damages of any kind arising out of or in connection with the use of or reliance upon the information provided. ©2008 All Rights Reserved.