

**DURBIN INDUSTRIAL VALVE, Inc.**



D364-40061 Durbin  
Model "V" Control Valves





## Durbin Model "V" Control Valves

### Features:

Instrument Air:  
3~15 PSI (0.21~1.03 bar)

Maximum Pressure:  
250 PSI (17 bar)

Maximum Temperature:  
450° F (232° C)

Standard Port Sizes:  
1/2"- 1 1/4" NPT

BSPT PORT SIZES ALSO AVAILABLE UPON REQUEST

### Cv Ratings:

6.5  
11.0  
15.0

For:  
Water (Hot or Cold)  
Inert Gases  
Steam



The Model "V" is a soft-seated, positive shut off control valve used in areas where precise pressure and temperature control is needed.

The highest quality material was selected to manufacture the Model "V". The body is constructed from a cast 17-4 stainless steel for strength. The disc, seat and stem are also made from 17-4 stainless steel to increase the durability of the valve. The disc is also combined with a replaceable soft seat seal to assure a positive shut off.

The Model "V" has a diaphragm operating range of 3 PSI to 15 PSI. The reverse acting (normally open) Model "V" requires air to close, while the direct acting (normally closed) model requires air to open.

# DURBIN VALVE



The Durbin Model "V" is a positive shutoff, soft seated control valve used in areas where precise pressure and temperature control is needed. The model "V" is a diaphragm operated pneumatic valve. It has a control region from 3~15 PSI (instrument air) The normally closed model requires air to open, while the normally open model requires air to close.

Maximum allowable pressures vary according to valve selection (see allowable pressure chart).

Maximum allowable temperature for all versions of the Model "V" is 450° F.

The Model "V" is primarily constructed of stainless steel components. The body and trim are constructed out of 17-4 ph stainless steel. The material selected for these two components has proven to be superior in overcoming the effects of corrosion, cavitation, and wiredraw.

The specially designed seal for the Model "V" is constructed from a high strength, high temperature thermal plastic. It is soft enough to provide a positive shut off, but hard enough to withstand the harsh environment it will be used in.

The Model "V" is available on request in a fully stainless version for use in applications where only stainless construction is permitted.

Use the following pages to make a selection as to which Model "V" suits your selection.

NORMALLY CLOSED				WEIGHT	
VALVE NUMBER	TRIM SIZE	PORT SIZE	TOP SIZE	LBS	Kg.
D354-40061	1/2"	1/2" NPT	1	13	5.9
D354-40071	1/2"	1/2" NPT	2	30	13.6
D354-40561	1/2"	3/4" NPT	1	13	5.9
D354-50071	3/4"	3/4" NPT	2	30	13.6
D354-50671	3/4"	1" NPT	2	30	13.6
D354-51671	1"	1" NPT	2	30	13.6
D354-51771	1"	1-1/4" NPT	2	30	13.6
D358-50071	3/4"	3/4" NPT	2H	30	13.6
D358-51671	1"	1" NPT	2H	30	13.6
D358-51771	1"	1-1/4" NPT	2H	30	13.6

NORMALLY OPEN				WEIGHT	
VALVE NUMBER	TRIM SIZE	PORT SIZE	TOP SIZE	LBS	Kg.
D364-40061	1/2"	1/2" NPT	1	13	5.9
D364-40071	1/2"	1/2" NPT	2	30	13.6
D364-40561	1/2"	3/4" NPT	1	13	5.9
D364-50071	3/4"	3/4" NPT	2	30	13.6
D364-50671	3/4"	1" NPT	2	30	13.6
D364-51671	1"	1" NPT	2	30	13.6
D364-51771	1"	1-1/4" NPT	2	30	13.6

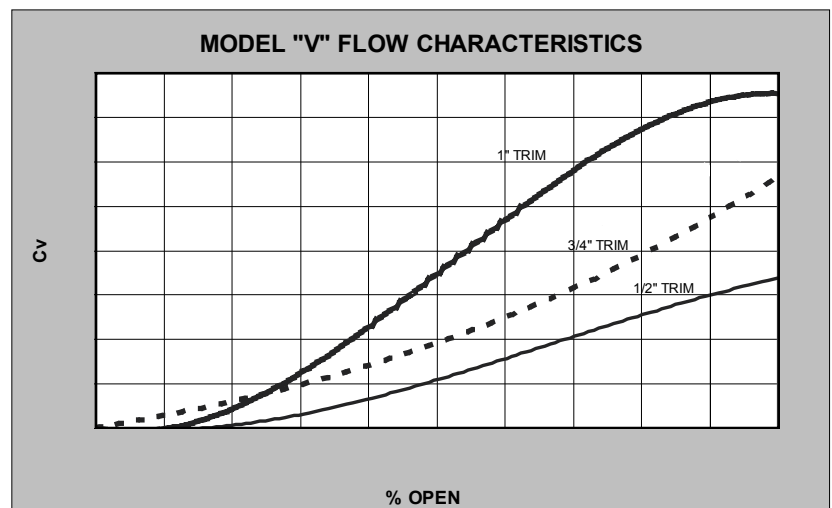



Parts List

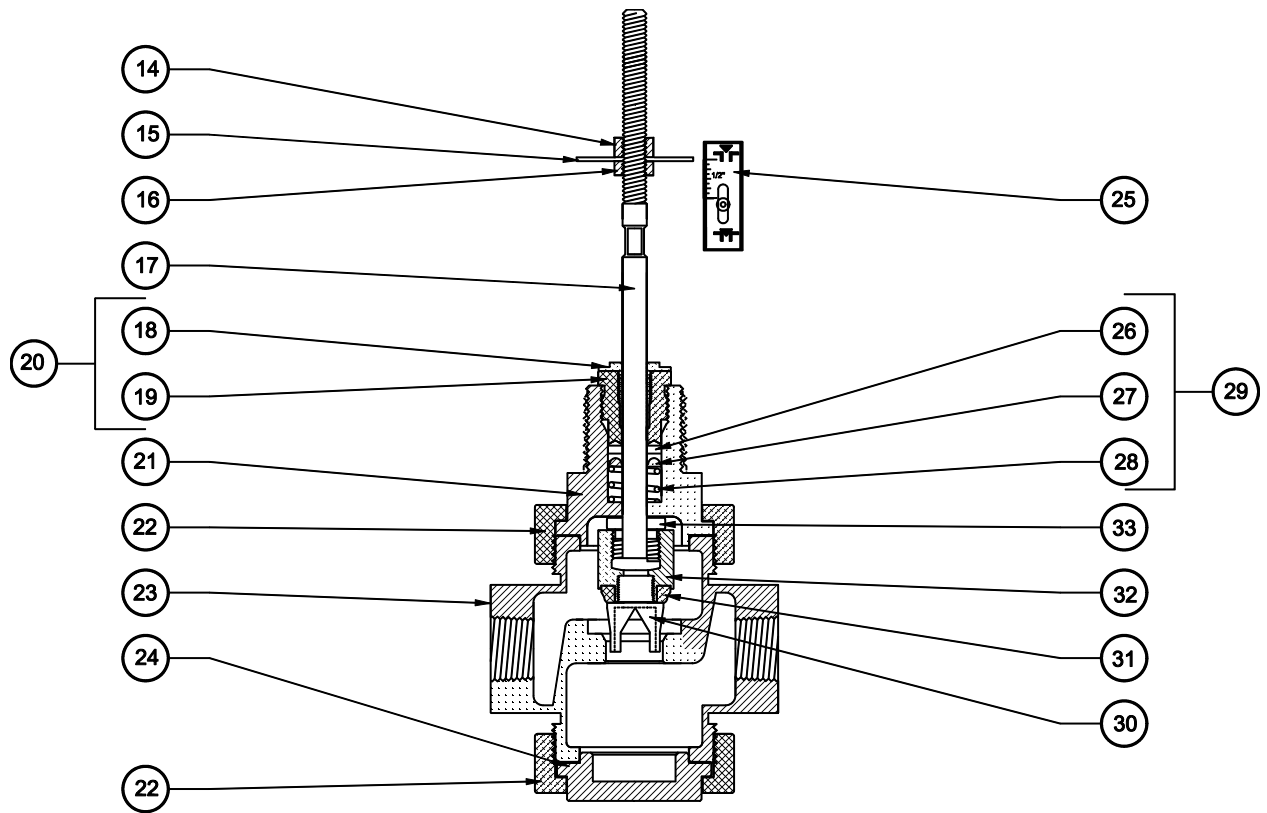

VALVE MODEL NUMBER NORMALLY OPEN SERIES, LOWER ASSEMBLY								
ITEM	DESCRIPTION	D364-40061	D364-40071	D364-40561	D364-50071	D364-50671	D364-51671	D364-51771
14	UPPER LOCK NUT	C133-005D	C133-005D	C133-005D	C133-005D	C133-005D	C133-005D	C133-005D
15	INDICATOR WASHER	C593-011D	C593-011D	C593-011D	C593-011D	C593-011D	C593-011D	C593-011D
16	LOWER LOCK NUT	C133-008D	C133-008D	C133-008D	C133-008D	C133-008D	C133-008D	C133-008D
17	N/O STEM	C853-090D	C853-090D	C853-090D	C853-090D	C853-090D	C853-090D	C853-090D
18	PACKING NUT BUSHING	VP524	VP524	VP524	VP524	VP524	VP524	VP524
19	PACKING NUT	C853-092D	C853-092D	C853-092D	C853-092D	C853-092D	C853-092D	C853-092D
20	PACKING NUT ASSY.	C853-090D	C853-090D	C853-090D	C853-090D	C853-090D	C853-090D	C853-090D
21	PACKING GLAND	C113-058D	C113-058D	C113-058D	C113-059D	C113-059D	C113-057D	C113-057D
22	UNION NUT (x2)	C663-022D	C663-022D	C663-022D	C663-026D	C663-026D	C663-026D	C663-026D
23	BODY W/ INTEGRAL SEAT	VP400	VP400	VP401	VP505	VP508	VP506	VP507
24	BOTTOM CAP	C213-016D	C213-016D	C213-016D	C213-020D	C213-020D	C213-020D	C213-020D
25	N/O INDICATOR TAG	C008D	C008D	C008D	C010D	C010D	C010D	C010D
26	PACKERS (x3)	C683-069D	C683-069D	C683-069D	C683-069D	C683-069D	C683-069D	C683-069D
27	PACKING SPREADER	C713-012D	C713-012D	C713-012D	C713-012D	C713-012D	C713-012D	C713-012D
28	PACKING SPRING	D293-104D	D293-104D	D293-104D	D293-104D	D293-104D	D293-104D	D293-104D
29	PACKING KIT	C242-015D	C242-015D	C242-015D	C242-015D	C242-015D	C242-015D	C242-015D
30	LOWER DISC	C553-007D	C553-007D	C553-007D	C343-023D	C343-023D	C343-025D	C343-025D
31	SEAL	C343-12VP	C343-12VP	C343-12VP	C343-34VP	C343-34VP	C343-10VP	C343-10VP
32	UPPER DISC	C913-008D	C913-008D	C913-008D	C343-022D	C343-022D	C343-024D	C343-024D
33	DISC NUT	C553-008D	C553-008D	C553-008D	C553-008D	C553-008D	C553-008D	C553-008D

REFER TO PAGE 14 FOR TOP ASSEMBLY PARTS LIST



## Parts List

TOP ASSEMBLY				
ITEM	DESCRIPTION	TOP NO.1	TOP NO.2	TOP NO.2H
1	LID/COVER	C293-023D	C293-030D	C293-030D
2	DIAPHRAGM	C333-053D	C333-051D	C333-051D
3	RING	C893-014D	C893-022D	C893-022D
4	YOKE	D283-021D	D283-061D	D283-061D
5	LOCK WASHER	H175-21	H175-21	H175-21
6	YOKE HEX BOLT	H096-55D	H096-49	H096-49
7	LID HEX BOLT	H096-10	H096-10	H096-10
8	LID HEX NUT	H060-03	H060-03	H060-03
9	PISTON	C783-043D	C783-068D	C783-068D
10	DIAPHRAGM SPRING	NC	D293-070D	D293-072D
		NO	D293-069D	D293-071D
11	UPPER STEM	D143-025D	D143-025D	D143-027D
12	SPRING ADJUSTING SCREW	C543-001D	C543-001D	C543-001D
13	SPRING ADJUSTING NUT	C133-009D	C133-010D	C133-010D

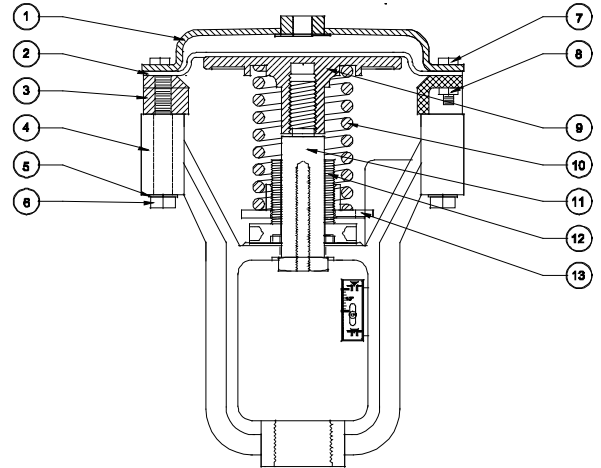

## Dimensions

TOP NO.	NORMALLY CLOSED			
	TRIM SIZE	1	2	2H
1/2"	250 PSI	250 PSI	-	-
3/4"	-	220 PSI	250 PSI	-
1"	-	150 PSI	250 PSI	-

TOP NO.	NORMALLY OPENED			
	TRIM SIZE	1	2	2H
1/2"	300 PSI	-	-	-
3/4"	-	250 PSI	-	-
1"	-	300 PSI	-	-

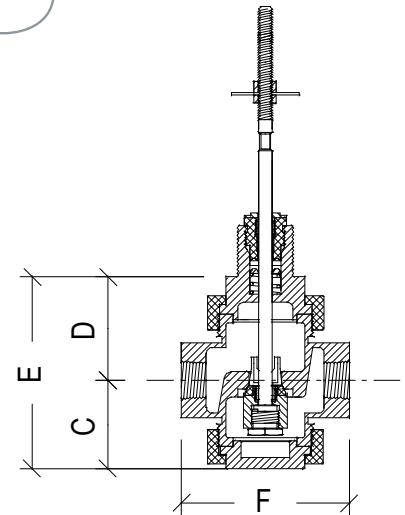
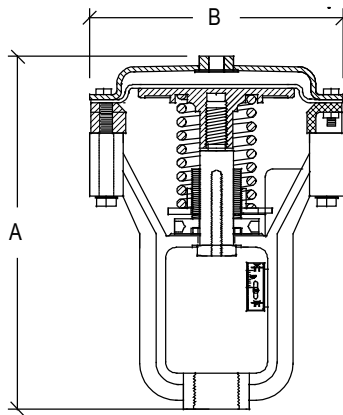

DIM.		TOP NO.1	TOP NO.2	TOP NO.2H
A	IN	10-3/8	9-5/8	9-5/8
	mm	264	245	245
B	IN	7-3/8	10-3/4	10-3/4
	mm	187	273	273

DIM.		1/2" BODY SIZE	3/4" BODY SIZE
C	IN	2	2-1/4
	mm	51	57
D	IN	2-1/4	2-5/8
	mm	57	67
E	IN	4-1/4	4-7/8
	mm	108	124
F	IN	3-3/4	4-1/4
	mm	95	108