

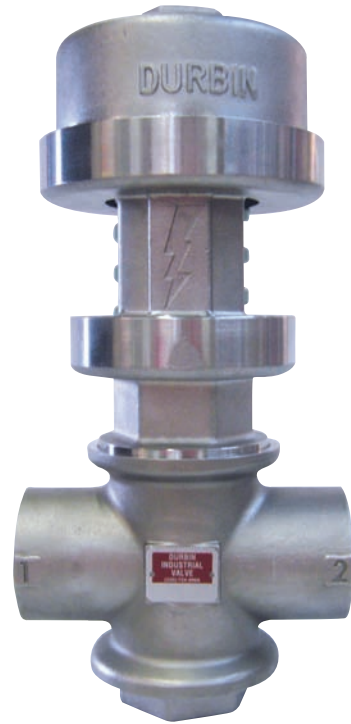

DURBIN

INDUSTRIAL VALVE, INC.

Cylinder Top Valve



Media Uses:

- Air, cold water, hot water, inert gases, steam, or vacuum service

Features:

- Soft Seated, Class VI positive shut off valve
- Pneumatically operated directional valve
- System pressures: up to a maximum of 500 psi (34 bar)
- Pilot air pressure range: from 40 psi to 100 psi (2.8 bar to 6.9 bar)
- Offered in 2 Way Normally Open, 2 & 3 Way Normally Closed
- Available ports in Standard NPT & BSP threads, flanged style, manifold style, and union body upon request
- System temperature ranges -40°F to 450°F (-40°C to 231°C)
- Wetted components constructed of cast & machined corrosion resistant stainless steel
- Engineered sealing edge meets highest ANSI/FCI 70-2 Class VI leakage rate standards

Benefits:

- Re-buildable valve; rebuild services offered by Durbin Industrial Valve, Inc., or field serviceable with Durbin Industrial Valve, Inc. Rebuild Kits
- Superior materials; more corrosion resistant materials that offer longer valve life
- Engineered for harsher applications; improved seal & seat materials
- Compact Size; smaller shape allows them to fit into applications where space is limited



DURBIN

INDUSTRIAL VALVE, INC.

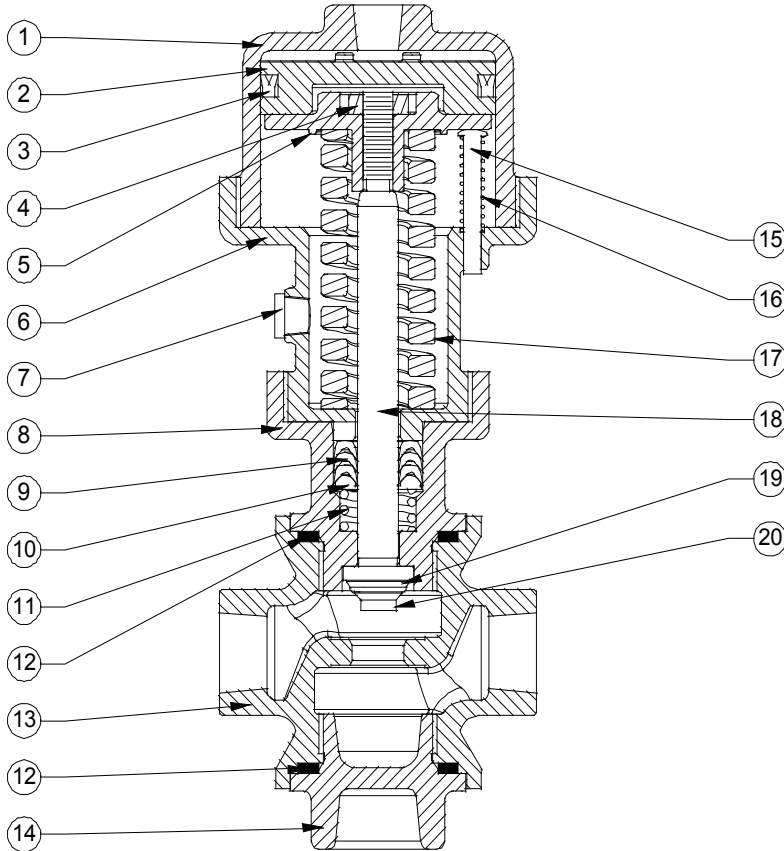

2-WAY NORMALLY OPEN

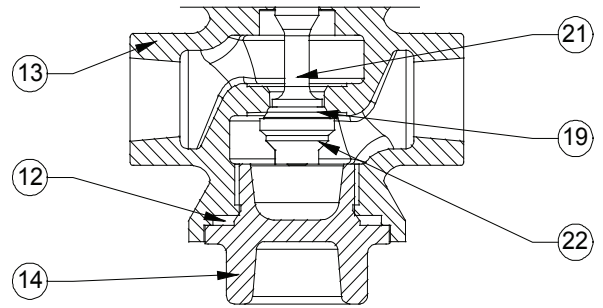

2-WAY NORMALLY CLOSED

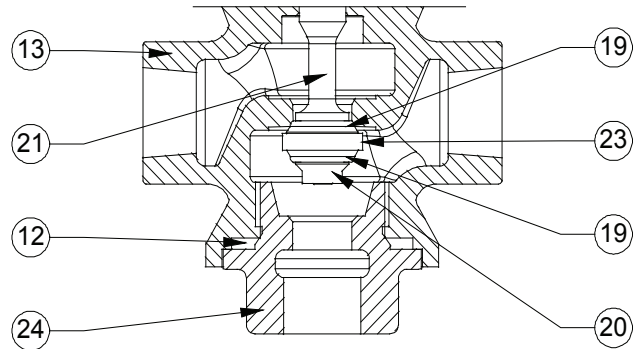

3-WAY NORMALLY CLOSED

DESCRIPTION	1/4" - 3/8" - 1/2"			3/4"			1"			1-1/2"		
	2W NO	2W NC	3W NC	2W NO	2W NC	3W NC	2W NO	2W NC	3W NC	2W NO	2W NC	3W NC
1 CYLINDER/COVER	DCT-103	DCT-103	DCT-103	DCT-203	DCT-203	DCT-203	DCT-303	DCT-303	DCT-303	DCT-503	DCT-503	DCT-503
2 PISTON	DCT-104	DCT-104	DCT-104	DCT-204	DCT-204	DCT-204	DCT-304	DCT-304	DCT-304	DCT-504	DCT-504	DCT-504
3 PISTON SEAL	DCT-130	DCT-130	DCT-130	DCT-230	DCT-230	DCT-230	DCT-330	DCT-330	DCT-330	DCT-530	DCT-530	DCT-530
4 LOCKING NUT	DCT-131	DCT-131	DCT-131	DCT-231	DCT-231	DCT-231	DCT-331	DCT-331	DCT-331	DCT-531	DCT-531	DCT-531
5 SPRING RETAINER	DCT-106	DCT-106	DCT-106	DCT-206	DCT-206	DCT-206	DCT-306	DCT-306	DCT-306	DCT-506	DCT-506	DCT-506
6 YOKE	DCT-109	DCT-109	DCT-109	DCT-209	DCT-209	DCT-209	DCT-309	DCT-309	DCT-309	DCT-509	DCT-509	DCT-509
7 REMOVABLE VENT	DCT-232	DCT-232	DCT-232	DCT-232	DCT-232	DCT-232	DCT-332	DCT-332	DCT-332	DCT-532	DCT-532	DCT-532
8 PACKING GLAND	DCT-105	DCT-105	DCT-105	DCT-205	DCT-205	DCT-205	DCT-305	DCT-305	DCT-305	DCT-505	DCT-505	DCT-505
9 PACKING	C242-024D	C242-024D	C242-024D	C242-021D	C242-021D	C242-021D	C242-022D	C242-022D	C242-022D	C242-023D	C242-023D	C242-023D
10 SPREADER	C713-017D	C713-017D	C713-017D	C713-003D	C713-003D	C713-003D	C713-004D	C713-004D	C713-004D	C713-007D	C713-007D	C713-007D
11 PACKING SPRING	D293-131D	D293-131D	D293-131D	D293-001D	D293-001D	D293-001D	D293-002D	D293-002D	D293-002D	D293-004D	D293-004D	D293-004D
12 GASKET	C383-063D	C383-063D	C383-063D	C383-022D	C383-022D	C383-022D	C383-028D	C383-028D	C383-028D	C383-032D	C383-032D	C383-032D
13 NPT INLINE BODY	DCT-101	DCT-101	DCT-101	DCT-201	DCT-201	DCT-201	DCT-301	DCT-301	DCT-301	DCT-501	DCT-501	DCT-501
13 BRITISH PIPE TAP BODY	DCT-101B	DCT-101B	DCT-101B	DCT-201B	DCT-201B	DCT-201B	DCT-301B	DCT-301B	DCT-301B	DCT-501B	DCT-501B	DCT-501B
13 ANSI FLANGED BODY	DCT-101F-1/2"	DCT-101F-1/2"	DCT-101F-1/2"	DCT-201F	DCT-201F	DCT-201F	DCT-301F	DCT-301F	DCT-301F	DCT-501F	DCT-501F	DCT-501F
13 DN20 DIN FLANGED BODY	DCT-101DIN-1/2"	DCT-101DIN-1/2"	DCT-101DIN-1/2"	DCT-201DIN	DCT-201DIN	DCT-201DIN	DCT-301DIN	DCT-301DIN	DCT-301DIN	DCT-501DIN	DCT-501DIN	DCT-501DIN
13 20 JIS FLANGED BODY	DCT-101JIS-1/2"	DCT-101JIS-1/2"	DCT-101JIS-1/2"	DCT-201JIS	DCT-201JIS	DCT-201JIS	DCT-301JIS	DCT-301JIS	DCT-301JIS	DCT-501JIS	DCT-501JIS	DCT-501JIS
14 2-WAY BOTTOM CAP	DCT-100	DCT-100	DCT-100	DCT-200	DCT-200	DCT-200	DCT-300	DCT-300	DCT-300	DCT-500	DCT-500	DCT-500
15 INDICATOR PIN	DCT-222	DCT-222	DCT-222	DCT-222	DCT-222	DCT-222	DCT-222	DCT-222	DCT-222	DCT-222	DCT-222	DCT-222
16 PIN RETURN SPRING	DCT-233	DCT-233	DCT-233	DCT-233	DCT-233	DCT-233	DCT-233	DCT-233	DCT-233	DCT-233	DCT-233	DCT-233
17 CYLINDER SPRING	DCT-134	DCT-134	DCT-134	DCT-234	DCT-234	DCT-234	DCT-334	DCT-334	DCT-334	DCT-534	DCT-534	DCT-534
18 NORMALLY OPEN STEM	DCT-121	-N/A-	-N/A-	DCT-221	-N/A-	-N/A-	DCT-321	-N/A-	-N/A-	DCT-521	-N/A-	-N/A-
19 STEM SEAL	DCT-127	DCT-127	DCT-127	C343-12VP	C343-12VP	C343-12VP	C343-069D	C343-069D	C343-069D	DCT-527	DCT-527	DCT-527
20 N/O STEM NUT	DCT-126	-N/A-	DCT-126	C553-022D	-N/A-	C553-022D	C353-024D	-N/A-	C353-024D	DCT-528	-N/A-	DCT-528
21 N/C - 3W STEM	-N/A-	DCT-120	DCT-120	-N/A-	DCT-220	DCT-220	-N/A-	DCT-320	DCT-320	-N/A-	DCT-520	DCT-520
22 N/C STEM NUT	-N/A-	DCT-124	-N/A-	-N/A-	C553-019D	-N/A-	-N/A-	C553-023D	-N/A-	-N/A-	C553-025D	-N/A-
23 DISC WASHER	-N/A-	-N/A-	DCT-125	-N/A-	-N/A-	C553-012D	-N/A-	-N/A-	C353-013D	-N/A-	-N/A-	C353-014D
24 3 WAY BOTTOM CAP	-N/A-	-N/A-	DCT-102	-N/A-	-N/A-	DCT-202	-N/A-	-N/A-	DCT-302	-N/A-	-N/A-	DCT-502



DURBIN

INDUSTRIAL VALVE, INC.

NPT-BODY STYLE

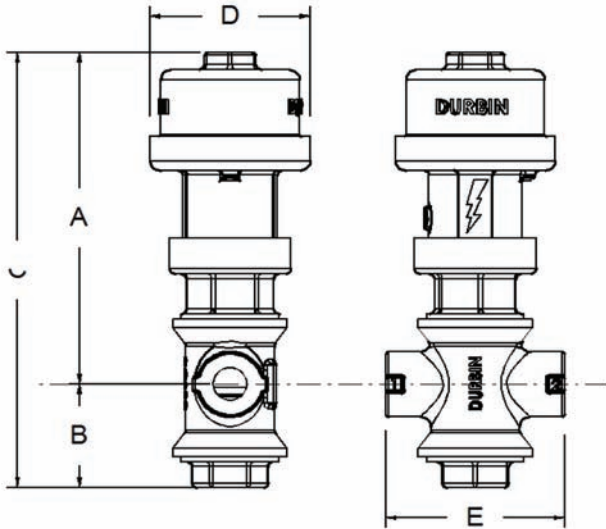

FLANGED-BODY STYLE

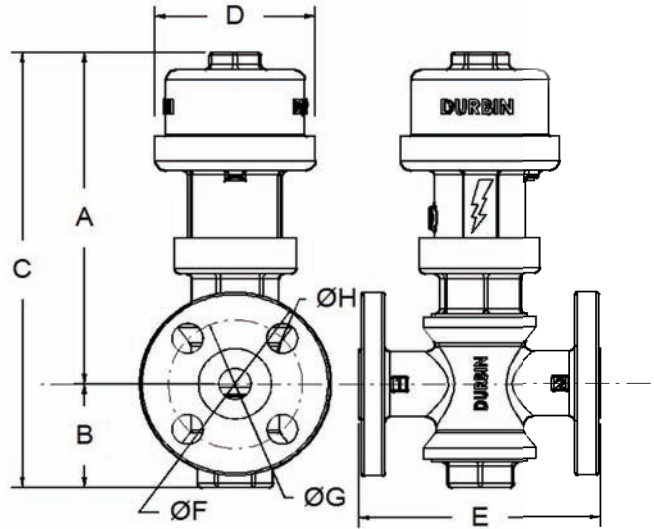

ITEM		1/4" - 1/2"	3/4"	1" - 1 1/4"	1 1/2"
A	IN	6.51	8.37	9.62	11.86
	mm	165.0	213.0	244.0	301.0
B	IN	1.97	2.61	2.78	3.60
	mm	50.0	66.0	71.0	91.0
C	IN	8.48	10.98	12.40	15.46
	mm	215.0	279.0	315.0	393.0
D	IN	3.36	3.89	5.13	6.17
	mm	85.0	99.0	130.0	157.0
E	IN	3.35	4.33	4.73	5.90
	mm	85.0	110.0	120.0	150.0

ITEM		1/4" - 1/2"	3/4"	1" - 1 1/4"	1 1/2"
A	IN	6.51	8.37	9.62	11.86
	mm	165.0	213.0	244.0	301.0
B	IN	1.97	2.61	2.78	3.60
	mm	50.0	66.0	71.0	91.0
C	IN	8.48	10.98	12.40	15.46
	mm	215.0	279.0	315.0	393.0
D	IN	3.36	3.89	5.13	6.17
	mm	85.0	99.0	130.0	157.0
E	IN	5.51	5.90	6.70	7.88
	mm	140.0	150.0	170.0	200.0
F	IN	3.75	4.63	4.88	6.13
	mm	95.0	118.0	124.0	156.0
G	IN	2.63	3.25	3.50	4.55
	mm	67.0	83.0	89.0	116.0
H	IN	0.63	0.75	0.75	0.88
	mm	16.0	19.0	19.0	22.0

Ordering Information

Example: PSI-214N4= 3/4", 2-Way, Normally Closed, 40psi Valve with NPT threaded ports

PSI																																									
	<table border="1" style="border-collapse: collapse; text-align: left;"> <tr><td>2W</td><td>2</td></tr> <tr><td>3W</td><td>3</td></tr> </table>	2W	2	3W	3	<table border="1" style="border-collapse: collapse; text-align: left;"> <tr><td>N/C</td><td>1</td></tr> <tr><td>N/O</td><td>2</td></tr> </table>	N/C	1	N/O	2	<table border="1" style="border-collapse: collapse; text-align: left;"> <tr><td>1/4"</td><td>1</td></tr> <tr><td>3/8"</td><td>2</td></tr> <tr><td>1/2"</td><td>3</td></tr> <tr><td>3/4"</td><td>4</td></tr> <tr><td>1"</td><td>5</td></tr> <tr><td>1-1/2"</td><td>7</td></tr> </table>	1/4"	1	3/8"	2	1/2"	3	3/4"	4	1"	5	1-1/2"	7	<table border="1" style="border-collapse: collapse; text-align: left;"> <tr><td>NPT</td><td>N</td></tr> <tr><td>BSP</td><td>B</td></tr> <tr><td>ANSI (300#)</td><td>A</td></tr> <tr><td>DIN (PN40)</td><td>D</td></tr> <tr><td>UNION</td><td>U</td></tr> <tr><td>MANIFOLD</td><td>M</td></tr> </table>	NPT	N	BSP	B	ANSI (300#)	A	DIN (PN40)	D	UNION	U	MANIFOLD	M	<table border="1" style="border-collapse: collapse; text-align: left;"> <tr><td>40 psi</td><td>4</td></tr> <tr><td>100 psi</td><td>1</td></tr> </table>	40 psi	4	100 psi	1
2W	2																																								
3W	3																																								
N/C	1																																								
N/O	2																																								
1/4"	1																																								
3/8"	2																																								
1/2"	3																																								
3/4"	4																																								
1"	5																																								
1-1/2"	7																																								
NPT	N																																								
BSP	B																																								
ANSI (300#)	A																																								
DIN (PN40)	D																																								
UNION	U																																								
MANIFOLD	M																																								
40 psi	4																																								
100 psi	1																																								

Cv Rating based on NPT threads • N/O is Normally Open and N/C is Normally Closed

Please contact us for more information at 330.724.9968 or visit us online at www.durbinvalve.com