

Durbin Industrial Valve
4-Way Spool Valves



DURBIN 4-WAY SPOOL VALVES

DURBIN INDUSTRIAL VALVE



Features:

Valve Type: Spool

Function: 4-Way

Action: Configuration dependent

Actuation: Pneumatic

Pilot Range: 40-100 psi (2.8-6.9 bar)

Sizes: ¼" (DN 6)

Pressure Ratings: Up to 225 psi (16 bar)

Temperature Ratings: -20°F to 200°F (-26°C to 93°C)

Connection Style: Threaded (NPT)

Seat Type: O-ring

Leakage Rate: ANSI/FCI 70-2 class VI

Cv: Maximum of 2.4

Media: Inert gas, air, and most hydraulic media

Overview: The Durbin 4-way spool valve is a two-position, pneumatically-shifted and spring-returned valve to serve your double-acting cylinder and other motion-control hydraulic and pneumatic needs.

Materials of Construction: The Durbin 4-way spool valve is constructed of 300 series stainless steel to protect against the damaging effects of corrosion. All wetted components are constructed from corrosion resistant materials (CRAs) or are high grade elastomeric materials.

Application: This valve series is ideal for applications where a high cycle life and repeated positive shut-off is required for your motion-control needs. This cylinder top design increases efficiency over its diaphragm-actuated or manually-actuated competitors.

DURBIN 4-WAY SPOOL VALVES

DURBIN INDUSTRIAL VALVE

DURBIN 4-WAY SPOOL VALVE DIMENSIONS

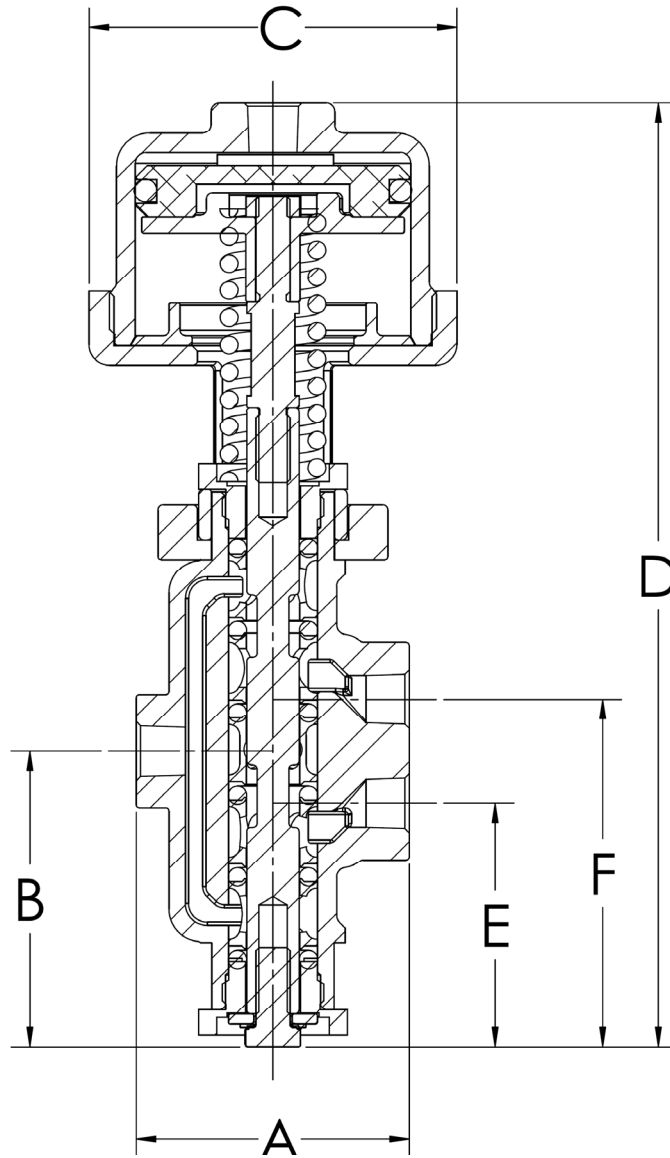

4-WAY CYLINDER TOP VALVE DIMENSIONS							
VALVE SIZE	UNITS	A	B	C	D	E	F
1/4"	IN	2.50	2.71	3.36	8.66	2.24	3.19
	mm	64.0	69.0	85.0	220.0	57.0	81.0

DURBIN 4-WAY SPOOL VALVES

DURBIN INDUSTRIAL VALVE

DURBIN 4-WAY SPOOL PARTS LIST

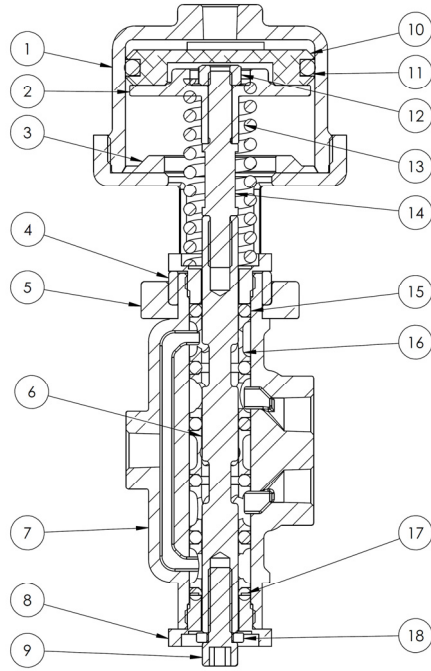

4-WAY CYLINDER TOP VALVE		
	VALVE NUMBER	DMOO-201-28
	SIZE	1/4"
ITEM	DESCRIPTION	PART #
1	LID	DCT-103
2	SPRING RET	DCT-106-SS
3	STEM STOP LID	DM563-002D
4	YOKE SPACER	DM083-003D
5	YOKE	DM573-004-SS
6	STEM	M373-044D
7	BODY	DM053-003D-SS
8	END BEARING	DM103-012D-SS
9	HEX BOLT 5/16	H096-26
10	PISTON	DCT-104
11	PISTON SEAL	DCT-130-ORING
12	HEX JAM NUT 5/16	C133-008D
13	SPRING	DM493-024D
14	UPPER STEM	DM143-100D
15	ORING	H134-87
16	SPACER	DM313-004D-SS
17	SHIM	M483-007D
18	WASHER	H177-05

DURBIN 4-WAY SPOOL VALVES

DURBIN INDUSTRIAL VALVE

DURBIN 4-WAY SPOOL VALVE SIZING CHART

VALVE SIZE	STYLE	DESCRIPTION	CV					
			PSI	BAR	PORT 1 TO PORT 2	PORT 1 TO PORT 3	PORT 2 TO PORT 4	PORT 3 TO PORT 4
1/4" NPT	4-WAY	MODEL	DM000-201-28		2.4	2.4	2	2.2
		PRESSURE RATING	225	16				

DURBIN 4-WAY SPOOL VALVE BASIC PIPING SCHEMATIC

