

Durbin Industrial Valve
Regulating Valve Series



DURBIN REGULATING VALVES

DURBIN INDUSTRIAL VALVE



Features:

Valve Type: [Globe](#)

Function: Regulating

Action: Normally Closed

Actuation: Pneumatic/sensing line

Pilot Range: 90 psi maximum (6.2 bar)

Sizes: ½" - 1¼" (DN 15 to DN 32)

Pressure Ratings: Up to 300 psi (21 bar)

Temperature Ratings: -40°F to 450°F (-40°C to 231°C)

Connection Style: Threaded (NPT/BSPT)

Seat Type: Soft Seat

Leakage Rate: ANSI/FCI 70-2 class VI

Cv: Maximum of 17

Media: Most process fluid types; gas, liquids and steam

Overview: The Durbin Regulating Valve Series (RV) is engineered to deliver a true 1:1 ratio. A mechanical balancing system which is ideal for low pressure-regulating applications is provided by using instrument air to the top of the dome at the desired output of valve and by using system feedback to the bottom of the dome.

Materials of Construction: The RV's wetted components are made entirely from corrosion-resistant materials. The valve body, actuating stem and seat are all constructed from stainless steel. The valve seal is made from a durable thermoplastic that withstands high temperatures and extreme process conditions. The diaphragm is constructed from a durable PTFE material designed for continual service.

Application: The RV is ideal when precise turn-down pressures are required. This valve can also be used in conjunction with multiple solenoid valves to deliver a stepped pressure trace. This simple but reliable mechanical control system can meet the demands of most critical pressure-control systems without the use of a PID control loop.

DURBIN REGULATING VALVE DIMENSIONS

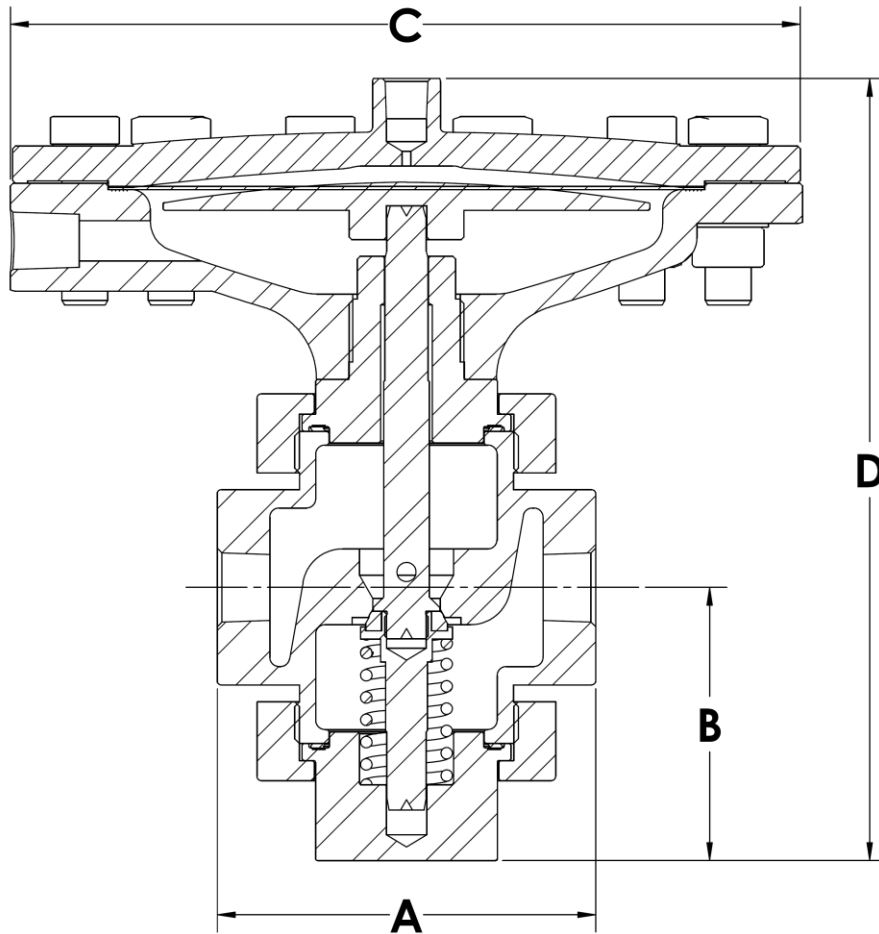

DURBIN REGULATING VALVE NPT DIMENSIONS					
ITEM		A	B	C	D
ALL RV VALVES	IN	4 1/8"	3"	8 5/8"	8 1/2"
	mm	105	76	219	216



DURBIN REGULATING VALVES

DURBIN INDUSTRIAL VALVE

DURBIN REGULATING VALVE PARTS LST

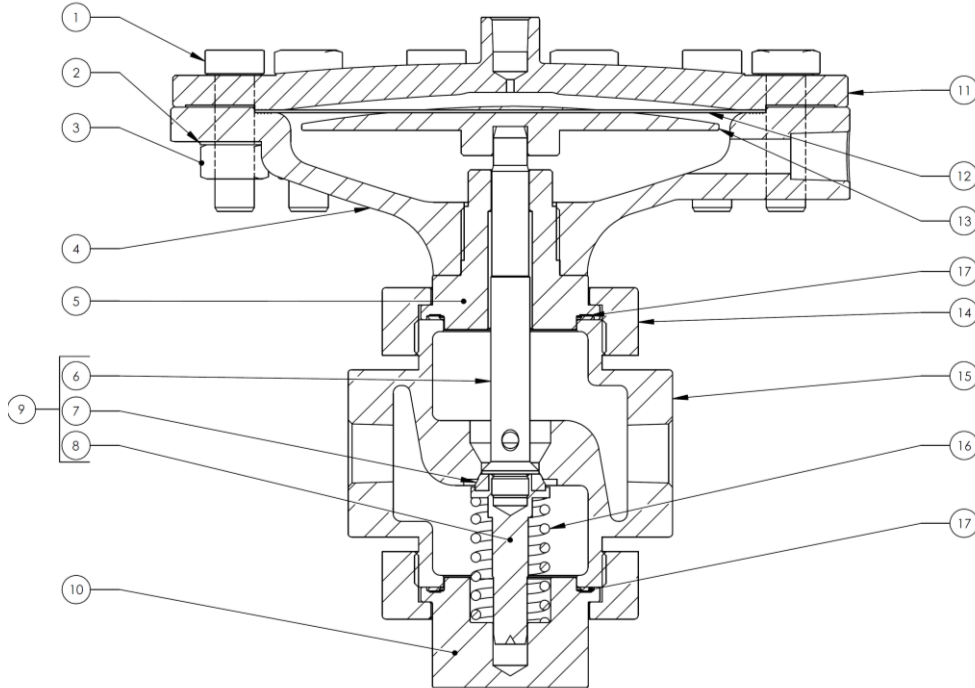

PRESSURE REDUCING VALVE					
	VALVE NUMBER	RV-4-SS	RV-5-SS	RV-6-SS	RV-7-SS
	SIZE	1/2" N/C	3/4" N/C	1" N/C	1 1/4" N/C
	Cv RATING	Cv 6.5	Cv 11	Cv 15	Cv 17
ITEM	DESCRIPTION	PART #	PART #	PART #	PART #
1	HEX BOLT 1/2	RV512	RV512	RV512	RV512
2	WASHER TOOTH	H174-08	H174-08	H174-08	H174-08
3	HEX NUT 1/2	RV513	RV513	RV513	RV513
4	DIAPHRAGM HOUSING	RV502-SS	RV502-SS	RV502-SS	RV502-SS
5	PACKING GLAND	RV508-SS	RV508-SS	RV508-SS	RV508-SS
6	UPPER STEM	RV407	RV507	RV607	RV607
7*	SEAL	C343-12VP	C343-34VP	C343-10VP	C343-10VP
8	LOWER STEM	RV405	RV505	RV605	RV605
9	STEM ASSEMBLY	RV415	RV515	RV615	RV615
10	BOTTOM CAP	RV503-SS	RV503-SS	RV603-SS	RV603-SS
11	LID	RV510-STR	RV510-STR	RV510-STR	RV510-STR
12*	DIAPHRAGM	RV511	RV511	RV511	RV511
13	PISTON	RV509-SS	RV509-SS	RV509-SS	RV509-SS
14	UNION NUT	C663-026D-SS	C663-026D-SS	C663-026D-SS	C663-026D-SS
15	BODY	RV400-SS	RV500-SS	RV600-SS	RV700-SS
16	SPRING	D293-003D	D293-003D	D293-021D	D293-021D
17*	GASKET	C383-082D	C383-082D	C383-082D	C383-082D
	SERVICE KIT	RV417-S	RV517-S	RV617-S	RV717-S



DURBIN REGULATING VALVES

DURBIN INDUSTRIAL VALVE

DURBIN REGULATING VALVE PIPING SCHEMATIC

